

VILL:- KALIKAPUR, UPERBERA & RAMCHANDRAPUR. (50) (68) (452)

THANA NO.:- 50, 68, & 452.

THANA:- SERAIKELLA.

DIST.:- SINGHBHUM (W.)

SCALE:- 16" = 1 MILE.

INDUSTRIAL PLOT SHOWN THUS (9.70 ACRES) - [Hatched Box]

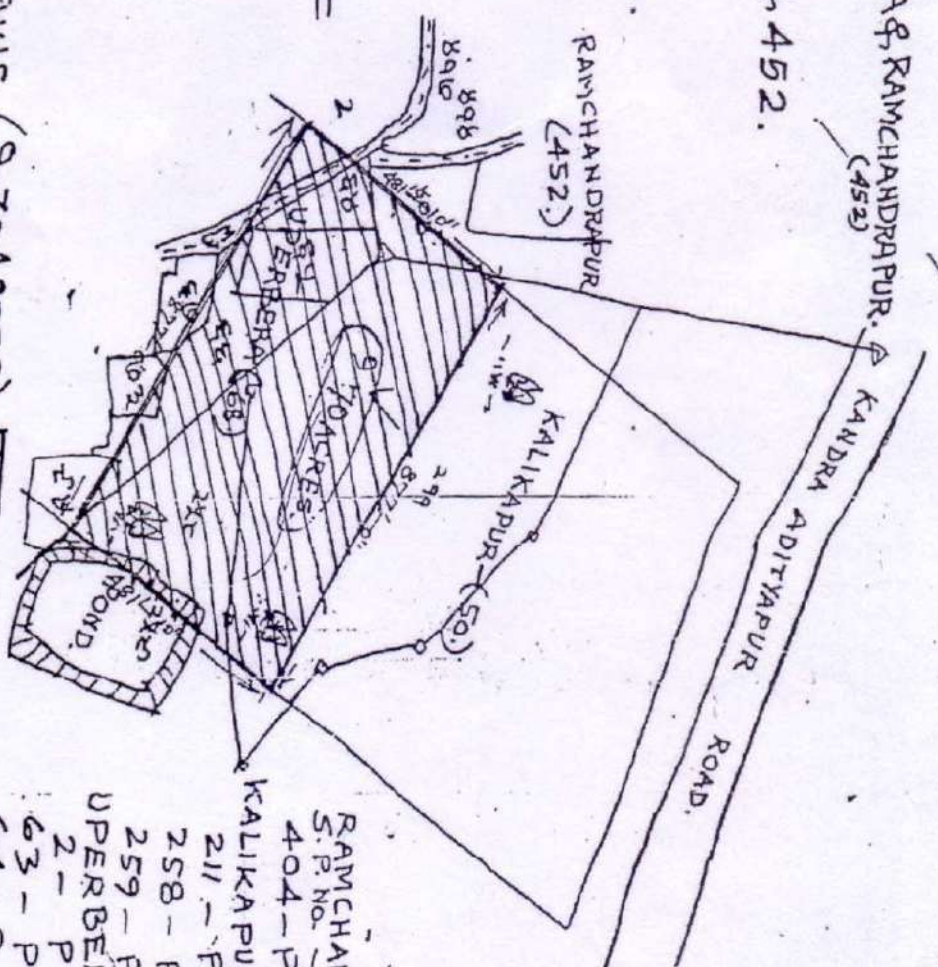

RAMCHANDRAPUR	211 - P - 43.
S.P. NO. KHATANO	258 - P - 44.
404 - P - 50.	259 - P - 40.
KALIKAPUR.	UPERBERA.
	2 - P - 37.
	63 - P - 38.
	64 - P - 37.
	65 - F - 33.
	66 - P - 37.
	67 - P - 33.
	73 - P - 37.
	74 - P - 12.

TOTAL AREA:- 9.70 ACS.

*H. Sharma*  
Principal  
Govt. Women's Technical Institute  
Jamsil  
G.O. No. 215/89

DRAFTSMAN - S.D. MANI, I.E.O.  
A.L.A.D.A.

*Janu-91*